

Collets

and
accessories



grinding deserves SOLUTIONS

GDS[®]
Made in Germany



INHALT

μGrind HPS20 collets	4-5
HPS overview and accessories	6-7
Nann collets 3148E	8
Nann collets 3409E	9
Nann collets 3718E	10-11
Nann collets 3851E	12-13
CoFix for Nann collets	14-15
Overview use of Nann collets	16-19
GDS trading partners	20-23

Status October 2021

Collets

Optimal grinding solutions require extreme precision paired with an efficient and flexible loading system on your machine.

To meet these requirements, GDS has developed new clamping and balancing systems.

“Our quality for your success“

All clamping and balancing solutions needed for high-precision tool grinding from one source. Customized solutions for your grinding and workpiece spindles are available on request.

GDS - precision is our passion



Competence and Innovation

Our collets are characterized by:



Highest accuracy by using modern measurement techniques.



Perfect fit and optimum radial and axial runout.



Ruggedness due to use of tempered material and best heating treatments.



Optimum surface finish plus long lasting dimensional stability and precision.



Sustainability by excellent durability and repair options.

Shape A



Shape B



Shape C



Accessories flat collets:

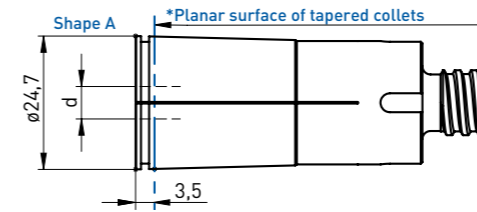

Item No.	Name - ϕ d	Shape
350260003	HPS collet 20 - ϕ 3 mm	A
350260004	HPS collet 20 - ϕ 4 mm	A
350260005	HPS collet 20 - ϕ 5 mm	A
350260006	HPS collet 20 - ϕ 6 mm	A
350260007	HPS collet 20 - ϕ 7 mm	A
350260008	HPS collet 20 - ϕ 8 mm	A
350260009	HPS collet 20 - ϕ 9 mm	A
350260010	HPS collet 20 - ϕ 10 mm	A
350260011	HPS collet 20 - ϕ 11 mm	A
350260012	HPS collet 20 - ϕ 12 mm	A
350260013	HPS collet 20 - ϕ 13 mm	A
350260014	HPS collet 20 - ϕ 14 mm	A
350260015	HPS collet 20 - ϕ 15 mm	A
350260016	HPS collet 20 - ϕ 16 mm	A
350260017	HPS collet 20 - ϕ 17 mm	A
350260018	HPS collet 20 - ϕ 18 mm	A
350260019	HPS collet 20 - ϕ 19 mm	A
350260020	HPS collet 20 - ϕ 20 mm	A
350260201	HPS collet 20 - ϕ 1/8"	A
350260202	HPS collet 20 - ϕ 3/16"	A
350260203	HPS collet 20 - ϕ 1/4"	A
350260204	HPS collet 20 - ϕ 5/16"	A
350260205	HPS collet 20 - ϕ 3/8"	A
350260206	HPS collet 20 - ϕ 7/16"	A
350260207	HPS collet 20 - ϕ 1/2"	A
350260208	HPS collet 20 - ϕ 9/16"	A
350260209	HPS collet 20 - ϕ 5/8"	A
350260210	HPS collet 20 - ϕ 11/16"	A
350260211	HPS collet 20 - ϕ 3/4"	A

Accessories tapered collets:

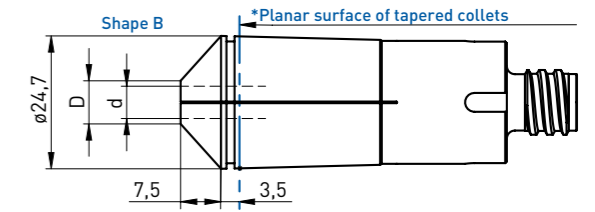

Item No.	Name - ϕ d	Shape
350260130	HPS collet 20K - ϕ 2,35 mm	B
350260103	HPS collet 20K - ϕ 3 mm	B
350260104	HPS collet 20K - ϕ 4 mm	B
350260105	HPS collet 20K - ϕ 5 mm	B
350260106	HPS collet 20K - ϕ 6 mm	B
350260301	HPS collet 20K - ϕ 1/8"	B
350260302	HPS collet 20K - ϕ 3/16"	B
350260303	HPS collet 20K - ϕ 1/4"	B

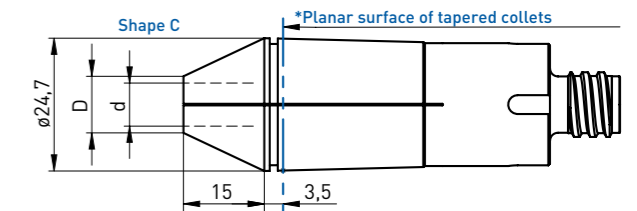

Item No.	Name - ϕ d	Shape
350260107	HPS collet 20K - ϕ 7 mm	C
350260108	HPS collet 20K - ϕ 8 mm	C
350260109	HPS collet 20K - ϕ 9 mm	C
350260110	HPS collet 20K - ϕ 10 mm	C
350260111	HPS collet 20K - ϕ 11 mm	C
350260112	HPS collet 20K - ϕ 12 mm	C
350260304	HPS collet 20K - ϕ 5/16"	C
350260305	HPS collet 20K - ϕ 3/8"	C
350260306	HPS collet 20K - ϕ 7/16"	C
350260307	HPS collet 20K - ϕ 1/2"	C



Minimum clamping depth of 2,5 x ϕ from *clamping chuck's plane surface.



Item No.	Name
350270002	Alignment set HPS (excl. dial gauges)
350270003	Dial gauges (2 pcs.)



! Approved for collets up to $\varnothing 12$ mm or 1/2" inch



Item No.	Name - ø d
350261123	Nann collet 3148E ø1 mm
350261101	Nann collet 3148E ø2 mm
350261102	Nann collet 3148E ø2,5 mm
350261103	Nann collet 3148E ø3 mm
350261104	Nann collet 3148E ø3,5 mm
350261105	Nann collet 3148E ø4 mm
350261106	Nann collet 3148E ø4,5 mm
350261107	Nann collet 3148E ø5 mm
350261108	Nann collet 3148E ø5,5 mm
350261109	Nann collet 3148E ø6 mm
350261110	Nann collet 3148E ø6,5 mm
350261111	Nann collet 3148E ø7 mm
350261112	Nann collet 3148E ø7,5 mm
350261113	Nann collet 3148E ø8 mm
350261114	Nann collet 3148E ø8,5 mm
350261115	Nann collet 3148E ø9 mm
350261116	Nann collet 3148E ø9,5 mm
350261117	Nann collet 3148E ø10 mm
350261118	Nann collet 3148E ø1/8"
350261119	Nann collet 3148E ø3/16"
350261120	Nann collet 3148E ø1/4"
350261121	Nann collet 3148E ø5/16"
350261122	Nann collet 3148E ø3/8"

Item No.	Name - ø d
350261200	Nann collet 3148E ø2 mm extended
350261201	Nann collet 3148E ø2,5 mm extended
350261202	Nann collet 3148E ø3 mm extended
350261203	Nann collet 3148E ø3,5 mm extended
350261204	Nann collet 3148E ø4 mm extended
350261205	Nann collet 3148E ø4,5 mm extended
350261206	Nann collet 3148E ø5 mm extended
350261207	Nann collet 3148E ø5,5 mm extended
350261208	Nann collet 3148E ø6 mm extended
350261209	Nann collet 3148E ø6,5 mm extended
350261210	Nann collet 3148E ø7 mm extended
350261211	Nann collet 3148E ø7,5 mm extended
350261212	Nann collet 3148E ø8 mm extended
350261213	Nann collet 3148E ø8,5 mm extended
350261214	Nann collet 3148E ø9 mm extended
350261215	Nann collet 3148E ø9,5 mm extended
350261216	Nann collet 3148E ø10 mm extended
350261217	Nann collet 3148E ø1/8" extended
350261218	Nann collet 3148E ø3/16" extended
350261219	Nann collet 3148E ø1/4" extended
350261220	Nann collet 3148E ø5/16" extended
350261221	Nann collet 3148E ø3/8" extended



Item No.	Name - ø d
350261300	Nann collet 3409E ø3 mm
350261301	Nann collet 3409E ø3,5 mm
350261302	Nann collet 3409E ø4 mm
350261303	Nann collet 3409E ø4,5 mm
350261304	Nann collet 3409E ø5 mm
350261305	Nann collet 3409E ø5,5 mm
350261306	Nann collet 3409E ø6 mm
350261307	Nann collet 3409E ø6,5 mm
350261308	Nann collet 3409E ø7 mm
350261309	Nann collet 3409E ø7,5 mm
350261310	Nann collet 3409E ø8 mm
350261311	Nann collet 3409E ø8,5 mm
350261312	Nann collet 3409E ø9 mm
350261313	Nann collet 3409E ø9,5 mm
350261314	Nann collet 3409E ø10 mm
350261315	Nann collet 3409E ø10,5 mm
350261316	Nann collet 3409E ø11 mm
350261317	Nann collet 3409E ø11,5 mm
350261318	Nann collet 3409E ø12 mm
350261319	Nann collet 3409E ø12,5 mm
350261320	Nann collet 3409E ø13 mm
350261321	Nann collet 3409E ø13,5 mm
350261322	Nann collet 3409E ø14 mm
350261323	Nann collet 3409E ø14,5 mm
350261324	Nann collet 3409E ø15 mm
350261325	Nann collet 3409E ø15,5 mm
350261326	Nann collet 3409E ø16 mm
350261327	Nann collet 3409E ø1/4"
350261328	Nann collet 3409E ø5/16"
350261329	Nann collet 3409E ø3/8"
350261330	Nann collet 3409E ø7/16"
350261331	Nann collet 3409E ø1/2"
350261332	Nann collet 3409E ø9/16"
350261333	Nann collet 3409E ø5/8"

Item No.	Name - ø d
350261400	Nann collet 3409E ø3 mm extended
350261401	Nann collet 3409E ø3,5 mm extended
350261402	Nann collet 3409E ø4 mm extended
350261403	Nann collet 3409E ø4,5 mm extended
350261404	Nann collet 3409E ø5 mm extended
350261405	Nann collet 3409E ø5,5 mm extended
350261406	Nann collet 3409E ø6 mm extended
350261407	Nann collet 3409E ø6,5 mm extended
350261408	Nann collet 3409E ø7 mm extended
350261409	Nann collet 3409E ø7,5 mm extended
350261410	Nann collet 3409E ø8 mm extended
350261411	Nann collet 3409E ø8,5 mm extended
350261412	Nann collet 3409E ø9 mm extended
350261413	Nann collet 3409E ø9,5 mm extended
350261414	Nann collet 3409E ø10 mm extended
350261415	Nann collet 3409E ø10,5 mm extended
350261416	Nann collet 3409E ø11 mm extended
350261417	Nann collet 3409E ø11,5 mm extended
350261418	Nann collet 3409E ø12 mm extended
350261419	Nann collet 3409E ø12,5 mm extended
350261420	Nann collet 3409E ø13 mm extended
350261421	Nann collet 3409E ø13,5 mm extended
350261422	Nann collet 3409E ø14 mm extended
350261423	Nann collet 3409E ø14,5 mm extended
350261424	Nann collet 3409E ø15 mm extended
350261425	Nann collet 3409E ø15,5 mm extended
350261426	Nann collet 3409E ø16 mm extended
350261427	Nann collet 3409E ø1/4" extended
350261428	Nann collet 3409E ø5/16" extended
350261429	Nann collet 3409E ø3/8" extended
350261430	Nann collet 3409E ø7/16" extended
350261431	Nann collet 3409E ø1/2" extended
350261432	Nann collet 3409E ø9/16" extended
350261433	Nann collet 3409E ø5/8" extended



Item No.	Name - ø d
350261517	Nann collet 3718E ø13,5 mm
350261518	Nann collet 3718E ø14 mm
350261519	Nann collet 3718E ø14,5 mm
350261520	Nann collet 3718E ø15 mm
350261522	Nann collet 3718E ø15,5 mm
350261523	Nann collet 3718E ø16 mm
350261524	Nann collet 3718E ø16,5 mm
350261525	Nann collet 3718E ø17 mm
350261526	Nann collet 3718E ø17,5 mm
350261527	Nann collet 3718E ø18 mm
350261528	Nann collet 3718E ø18,5 mm
350261529	Nann collet 3718E ø19 mm
350261530	Nann collet 3718E ø19,5 mm
350261531	Nann collet 3718E ø20 mm
350261532	Nann collet 3718E ø20,5 mm
350261533	Nann collet 3718E ø21 mm
350261534	Nann collet 3718E ø21,5 mm
350261535	Nann collet 3718E ø22 mm
350261536	Nann collet 3718E ø22,5 mm
350261537	Nann collet 3718E ø23 mm
350261538	Nann collet 3718E ø23,5 mm
350261539	Nann collet 3718E ø24 mm
350261540	Nann collet 3718E ø24,5 mm
350261541	Nann collet 3718E ø25 mm
350261542	Nann collet 3718E ø25,5 mm
350261543	Nann collet 3718E ø26 mm
350261544	Nann collet 3718E ø26,5 mm
350261545	Nann collet 3718E ø27 mm
350261546	Nann collet 3718E ø5/16"
350261547	Nann collet 3718E ø3/8"
350261548	Nann collet 3718E ø7/16"
350261549	Nann collet 3718E ø1/2"
350261550	Nann collet 3718E ø9/16"

Item No.	Name - ø d
350261500	Nann collet 3718E ø5 mm
350261501	Nann collet 3718E ø5,5 mm
350261502	Nann collet 3718E ø6 mm
350261503	Nann collet 3718E ø6,5 mm
350261504	Nann collet 3718E ø7 mm
350261505	Nann collet 3718E ø7,5 mm
350261506	Nann collet 3718E ø8 mm
350261507	Nann collet 3718E ø8,5 mm
350261508	Nann collet 3718E ø9 mm
350261509	Nann collet 3718E ø9,5 mm
350261510	Nann collet 3718E ø10 mm
350261511	Nann collet 3718E ø10,5 mm
350261512	Nann collet 3718E ø11 mm
350261513	Nann collet 3718E ø11,5 mm
350261514	Nann collet 3718E ø12 mm
350261515	Nann collet 3718E ø12,5 mm
350261516	Nann collet 3718E ø13 mm

Item No.	Name - ø d
350261551	Nann collet 3718E ø5/8"
350261552	Nann collet 3718E ø11/16"
350261553	Nann collet 3718E ø3/4"
350261554	Nann collet 3718E ø13/16"
350261555	Nann collet 3718E ø7/8"
350261556	Nann collet 3718E ø15/16"
350261557	Nann collet 3718E ø1"
350261558	Nann collet 3718E ø1.1/16"
350261600	Nann collet 3718E ø5 mm extended
350261601	Nann collet 3718E ø5,5 mm extended
350261602	Nann collet 3718E ø6 mm extended
350261603	Nann collet 3718E ø6,5 mm extended
350261604	Nann collet 3718E ø7 mm extended
350261605	Nann collet 3718E ø7,5 mm extended
350261606	Nann collet 3718E ø8 mm extended
350261607	Nann collet 3718E ø8,5 mm extended
350261608	Nann collet 3718E ø9 mm extended
350261609	Nann collet 3718E ø9,5 mm extended
350261610	Nann collet 3718E ø10 mm extended
350261611	Nann collet 3718E ø10,5 mm extended
350261612	Nann collet 3718E ø11 mm extended
350261613	Nann collet 3718E ø11,5 mm extended
350261614	Nann collet 3718E ø12 mm extended
350261615	Nann collet 3718E ø12,5 mm extended
350261616	Nann collet 3718E ø13 mm extended
350261617	Nann collet 3718E ø13,5 mm extended
350261618	Nann collet 3718E ø14 mm extended
350261619	Nann collet 3718E ø14,5 mm extended
350261620	Nann collet 3718E ø15 mm extended
350261621	Nann collet 3718E ø15,5 mm extended
350261622	Nann collet 3718E ø16 mm extended
350261623	Nann collet 3718E ø16,5 mm extended
350261624	Nann collet 3718E ø17 mm extended

Item No.	Name - ø d
350261625	Nann collet 3718E ø17,5 mm extended
350261626	Nann collet 3718E ø18 mm extended
350261627	Nann collet 3718E ø18,5 mm extended
350261628	Nann collet 3718E ø19 mm extended
350261629	Nann collet 3718E ø19,5 mm extended
350261630	Nann collet 3718E ø20 mm extended
350261631	Nann collet 3718E ø20,5 mm extended
350261632	Nann collet 3718E ø21 mm extended
350261633	Nann collet 3718E ø21,5 mm extended
350261634	Nann collet 3718E ø22 mm extended
350261635	Nann collet 3718E ø22,5 mm extended
350261636	Nann collet 3718E ø23 mm extended
350261637	Nann collet 3718E ø23,5 mm extended
350261638	Nann collet 3718E ø24 mm extended
350261639	Nann collet 3718E ø24,5 mm extended
350261640	Nann collet 3718E ø25 mm extended
350261641	Nann collet 3718E ø25,5 mm extended
350261642	Nann collet 3718E ø26 mm extended
350261643	Nann collet 3718E ø26,5 mm extended
350261644	Nann collet 3718E ø27 mm extended
350261645	Nann collet 3718E ø5/16" extended
350261646	Nann collet 3718E ø3/8" extended
350261647	Nann collet 3718E ø7/16" extended
350261648	Nann collet 3718E ø1/2" extended
350261649	Nann collet 3718E ø9/16" extended
350261650	Nann collet 3718E ø5/8" extended
350261651	Nann collet 3718E ø11/16" extended
350261652	Nann collet 3718E ø3/4" extended
350261653	Nann collet 3718E ø13/16" extended
350261654	Nann collet 3718E ø7/8" extended
350261655	Nann collet 3718E ø15/16" extended
350261656	Nann collet 3718E ø1" extended
350261657	Nann collet 3718E ø1.1/16" extended



Item No.	Name - ø d
350261739	Nann collet 3851E ø16 mm
350261700	Nann collet 3851E ø20 mm
350261701	Nann collet 3851E ø20,5 mm
350261702	Nann collet 3851E ø21 mm
350261703	Nann collet 3851E ø21,5 mm
350261704	Nann collet 3851E ø22 mm
350261705	Nann collet 3851E ø22,5 mm
350261706	Nann collet 3851E ø23 mm
350261707	Nann collet 3851E ø23,5 mm
350261708	Nann collet 3851E ø24 mm
350261709	Nann collet 3851E ø24,5 mm
350261710	Nann collet 3851E ø25 mm
350261711	Nann collet 3851E ø25,5 mm
350261712	Nann collet 3851E ø26 mm
350261713	Nann collet 3851E ø26,5 mm
350261714	Nann collet 3851E ø27 mm
350261715	Nann collet 3851E ø27,5 mm
350261716	Nann collet 3851E ø28 mm
350261740	Nann collet 3851E ø28,5 mm
350261717	Nann collet 3851E ø29 mm
350261718	Nann collet 3851E ø29,5 mm
350261719	Nann collet 3851E ø30 mm
350261720	Nann collet 3851E ø30,5 mm
350261721	Nann collet 3851E ø31 mm
350261722	Nann collet 3851E ø31,5 mm

Item No.	Name - ø d
350261723	Nann collet 3851E ø32 mm
350261724	Nann collet 3851E ø32,5 mm
350261725	Nann collet 3851E ø33 mm
350261726	Nann collet 3851E ø33,5 mm
350261727	Nann collet 3851E ø34 mm
350261728	Nann collet 3851E ø34,5 mm
350261729	Nann collet 3851E ø35 mm
350261730	Nann collet 3851E ø35,5 mm
350261731	Nann collet 3851E ø36 mm
350261732	Nann collet 3851E ø3/4"
350261733	Nann collet 3851E ø1"
350261734	Nann collet 3851E ø1.1/4"
350261735	Nann collet 3851E ø13/16"
350261736	Nann collet 3851E ø7/8"
350261737	Nann collet 3851E ø15/16"
350261738	Nann collet 3851E ø1.1/16"
350261826	Nann collet 3851E ø11 mm extended
350300134	Nann collet 3851E ø12 mm extended
350261825	Nann collet 3851E ø16 mm extended
350261800	Nann collet 3851E ø20 mm extended
350261801	Nann collet 3851E ø20,5 mm extended
350261802	Nann collet 3851E ø21 mm extended
350261803	Nann collet 3851E ø21,5 mm extended
350261804	Nann collet 3851E ø22 mm extended
350261805	Nann collet 3851E ø22,5 mm extended
350261806	Nann collet 3851E ø23 mm extended
350261807	Nann collet 3851E ø23,5 mm extended
350261808	Nann collet 3851E ø24 mm extended
350261809	Nann collet 3851E ø24,5 mm extended
350261810	Nann collet 3851E ø25 mm extended
350261811	Nann collet 3851E ø25,5 mm extended
350261812	Nann collet 3851E ø26 mm extended
350261813	Nann collet 3851E ø26,5 mm extended

Item No.	Name - ø d
350261814	Nann collet 3851E ø27 mm extended
350261815	Nann collet 3851E ø27,5 mm extended
350261816	Nann collet 3851E ø28 mm extended
350261817	Nann collet 3851E ø28,5 mm extended
350261818	Nann collet 3851E ø29 mm extended
350261819	Nann collet 3851E ø29,5 mm extended
350261820	Nann collet 3851E ø30 mm extended
350261821	Nann collet 3851E ø30,5 mm extended
350261822	Nann collet 3851E ø31 mm extended
350261823	Nann collet 3851E ø31,5 mm extended
350261824	Nann collet 3851E ø32 mm extended



Other diameters on request.



Accessories for Nann collets:

Item No.	Name
350060012	Cofix 20 (for W20 and Nann 3409E) Screw-in tool for collets
350060013	Cofix 12 (for W15 and Nann 3148E) Screw-in tool for collets
350060014	Cofix 32 (for Nann 3718E) Screw-in tool for collets
350060015	Cofix 45 (for Nann 3851E) Screw-in tool for collets

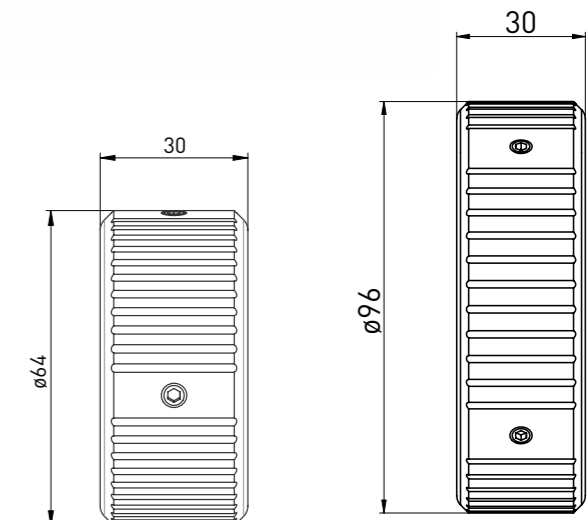

Accessories:

Item No.	Name
----------	------

350060013 Cofix 12
[for W15 and Nann 3148E]
Screw-in tool for collets

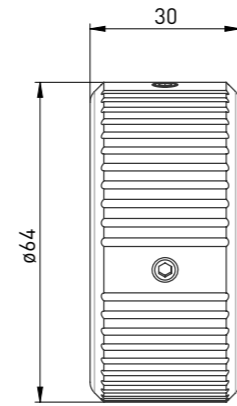

Accessories:

Item No.	Name
----------	------

350060014 Cofix 32
[for Nann 3718E]
Screw-in tool for collets

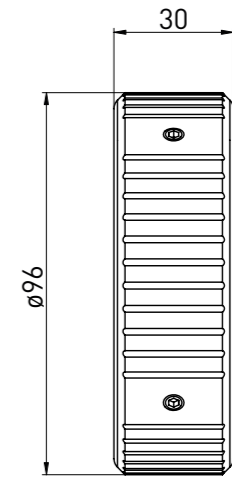

Accessories:

Item No.	Name
----------	------

350060012 Cofix 20
[for W20 and Nann 3409E]
Screw-in tool for collets

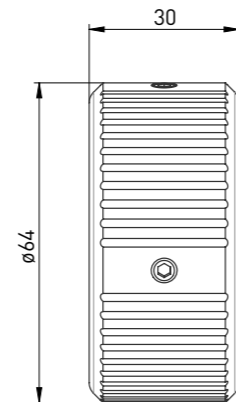

Accessories:

Item No.	Name
----------	------

350060015 Cofix 45
[for Nann 3851E]
Screw-in tool for collets

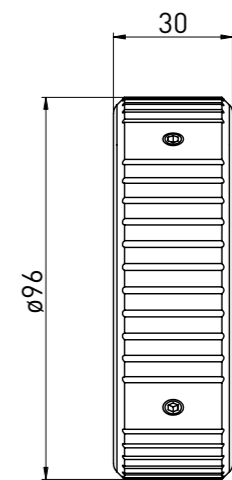





Nann 3409E

Collet - maximum bore $\varnothing 16$



Nann 3718E

Collet - maximum bore $\varnothing 27$



Nann 3851E

Collet - maximum bore $\varnothing 36$

VIPER M
Nann 3409E



VIPER M
Nann 3409E
Micro



VIPER M
Nann 3409E
Mini/G200



VIPER
L Nann 3718E



VIPER
XL Nann 3851E



COBRA
SK50 3409E
L68



COBRA
SK50 3409E
L98



COBRA
SK50 3718E
L60



COBRA
SK50 3718E
L90



COBRA
SK50 3851E
L60



Our certified partners **take care of you**, where we can't be in person, providing optimal support and answers to your questions.



Local GDS partners offer the complete line of original GDS grinding wheel adaptors as well as clamping and balancing solutions for tool grinding.

From consulting to order processing, please contact your local GDS partners.

GDS - precision is our passion



D- PLZ 0 - 6
Dr. MÜLLER DIAMANTMETALL AG
 Leprosenweg 34
 82362 Weilheim i. Ob.
 Tel: +49 (0) 881 - 90 11 55-0
 Fax: +49 (0) 881 - 90 11 55-100
 Email: vertrieb@muedia.de
 Web: www.muedia.de

D- PLZ 0 - 6 (Clamping and balancing technology)
Balletshofer Schleiftechnik
 Am Geiselbach 28
 86637 Zusamaltheim
 Mobil: +49 (0)1 70 - 3 44 54 74
 Fax: +49 (0) 82 96 - 90 98 96
 Email: info@balletshofer.com
 Web: www.balletshofer.com

D- PLZ 6 + 7
Fischer Präzisionswerkzeug-Maschinen GmbH & Co. KG
 Burghaldenstraße 2
 71065 Sindelfingen
 Tel: +49 (0) 70 31 - 81 10 - 25
 Fax: +49 (0) 70 31 - 81 10 - 27
 Email: info@hf-fischer.de
 Web: www.hf-fischer.de

D- PLZ 8 + 9
Balletshofer Schleiftechnik
 Am Geiselbach 28
 86637 Zusamaltheim
 Mobil: +49 (0)1 70 - 3 44 54 74
 Fax: +49 (0) 82 96 - 90 98 96
 Email: info@balletshofer.com
 Web: www.balletshofer.com



AUSTRIA
plan:b4u GmbH
 Colmarplatz 1 / Top XXIII
 7000 Eisenstadt Austria
 Tel: +43 664 127 3039
 Email: info@planb4u.com
 Web: www.planb4u.com

BELARUSSIA
AWM Precision GmbH
 Genshagener Straße 27
 14974 Ludwigsfelde Germany
 Tel: +49 (0) 33 78 - 5 18 63 67
 Email: arnold@awm-precision.com
 Web: www.awm-precision.com

BELGIUM
oelheld technologies SAS
 innovative fluid technology
 Technopôle de Forbach-Sud
 140, Avenue Jean-Eric Bousch
 57600 Oeting France
 Tel: +33 (0) 387-90 42 14
 Fax: +33 (0) 387-84 66 91
 Email: martin.gundelach@oelheld.de
 Web: www.oelheld.com

CZECH/SLOVAKIA
Dr. MÜLLER DIAMANTMETALL AG
 Leprosenweg 34
 82362 Weilheim i. Ob. Germany
 Tel: +49 (0) 881 - 90 11 55-0
 Fax: +49 (0) 881 - 90 11 55-100
 Email: vertrieb@muedia.de
 Web: www.muedia.de

DENMARK
M-Tech ApS
 Holkebjergvej 75
 5250 Odense SV Denmark
 Tel: +45 3034 1415
 Email: m-tech@jakobsen.mail.dk

ESTONIA
AWM Precision GmbH
 Genshagener Straße 27
 14974 Ludwigsfelde Germany
 Tel: +49 (0) 33 78 - 5 18 63 67
 Email: arnold@awm-precision.com
 Web: www.awm-precision.com

FINLAND
Diamack Oy
 Asentajankatu 9 C
 48770 Kotka Finland
 Tel: +358 5 - 21 41 20
 Fax: +358 5 - 21 41 70
 Email: diamack@diamack.fi
 Web: www.diamack.fi

FRANCE
oelheld technologies SAS
 innovative fluid technology
 Technopôle de Forbach-Sud
 140, Avenue Jean-Eric Bousch
 57600 Oeting France
 Tel: +33 (0) 387-90 42 14
 Fax: +33 (0) 387-84 66 91
 Email: martin.gundelach@oelheld.de
 Web: www.oelheld.com

HUNGARY
Szerszám Technika Kft.
 Dűlő u. 4.
 1225 Budapest Hungary
 Tel: +36 1 287 82 76
 Fax: +36 1 287 82 77
 Email: info@szerszamtechnika.hu
 Web: www.szerszamtechnika.hu

IRELAND
oelheld technologies SAS
 innovative fluid technology
 Technopôle de Forbach-Sud
 140, Avenue Jean-Eric Bousch
 57600 Oeting France
 Tel: +33 (0) 387-90 42 14
 Fax: +33 (0) 387-84 66 91
 Email: martin.gundelach@oelheld.de
 Web: www.oelheld.com

ITALY
Utensileria FAVRIN Srl
 Via Per Cabiate 79
 22066 Mariano Comense Italy
 Tel: +39 (0) 31 - 74 72 00
 Fax: +39 (0) 31 - 75 12 22
 Email: utensileria-mariano@favrin.it
 Web: www.utensileria-favrin.it

LATVIA
AWM Precision GmbH
 Genshagener Straße 27
 14974 Ludwigsfelde Germany
 Tel: +49 (0) 33 78 - 5 18 63 67
 Email: arnold@awm-precision.com
 Web: www.awm-precision.com

LITHUANIA
AWM Precision GmbH
 Genshagener Straße 27
 14974 Ludwigsfelde Germany
 Tel: +49 (0) 33 78 - 5 18 63 67
 Email: arnold@awm-precision.com
 Web: www.awm-precision.com

LUXEMBOURG
oelheld technologies SAS
 innovative fluid technology
 Technopôle de Forbach-Sud
 140, Avenue Jean-Eric Bousch
 57600 Oeting France
 Tel: +33 (0) 387-90 42 14
 Fax: +33 (0) 387-84 66 91
 Email: martin.gundelach@oelheld.de
 Web: www.oelheld.com

NETHERLANDS
oelheld technologies SAS
 innovative fluid technology
 Technopôle de Forbach-Sud
 140, Avenue Jean-Eric Bousch
 57600 Oeting France
 Tel: +33 (0) 387-90 42 14
 Fax: +33 (0) 387-84 66 91
 Email: martin.gundelach@oelheld.de
 Web: www.oelheld.com

POLAND
Vollmer Polska sp z o.o.
 ul.Handlowa 11
 41-807 Zabrze Poland
 Tel: +48 32 733 08 69
 Email: info-pl@vollmer-group.com
 Web: www.vollmer-group.com

PORTUGAL // SPAIN
Procut
 Parque Industrial Cruzeiro
 Rua Nossa Senhora da Ajuda 150
 4815-364 Moreira de Conegos Portugal
 Tel: +351 253 56 12 11
 Fax: +351 253 56 39 49
 Email: info@procut.pt
 Web: www.procut.pt

SWEDEN // NORWAY
Ehn & Land AB
 Bultvägen 4
 553 02 Jönköping Sweden
 Tel: +46 86 35 34-50
 Fax: +46 86 35 34-70
 Email: info@ehmland.se
 Web: www.ehmland.se

SWITZERLAND
Ziegler + Cie AG
 Industriestraße 12
 8404 Winterthur Switzerland
 Tel: +41 (0) 52 234 20 20
 Fax: +41 (0) 52 234 20 10
 Email: info@zieglerag.ch
 Web: www.zieglerag.ch

UNITED KINGDOM
oelheld UK Ltd
 Unit 16, Colomendy Business Park,
 Erw Las, Denbigh LL16 5TA, UK
 Tel: +44 (0)1745 814 777
 Fax: +44 (0)1745 813 222
 Email: sales@oelheld.co.uk
 Web: www.oelheld.co.uk

UKRAINE
AWM Precision GmbH
 Genshagener Straße 27
 14974 Ludwigsfelde Germany
 Tel: +49 (0) 33 78 - 5 18 63 67
 Email: arnold@awm-precision.com
 Web: www.awm-precision.com

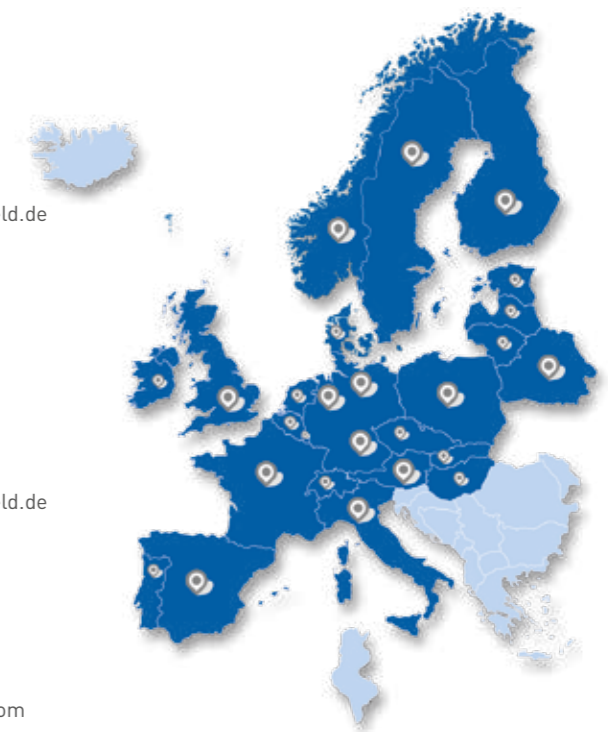

CHINA

HERZOG CHINA CO., LTD.

4/F, No.3232 Beimen Road,
Kunshan, Jiangsu 215316, China
Tel: +86-512-55 19 05 78
Fax: +86-512-55 19 05 76
Email: dezhu@herzog-china.com
Web: www.herzog-china.com

Changzhou Technology Service Center

West Street 255#, Xixiashu Town,
Xinbei District, Changzhou City,
Jiangsu Province, China
Tel: +86-519-83 85 09 55
Email: dezhu@herzog-china.com

South China Technology Service Center

FuYuan Business Center 206#, 1# 13th Alley,
MaiYuan Road, XinAn Community, ChangAn Town,
DongGuan City, GuangDong Province, China
Tel: +86-769-81 88 99 62
Email: dezhu@herzog-china.com

INDIA

TMS PRECISION TECH PVT. LTD

B2-302, Regency Cosmos
Baner Road, Pune: 411045 India
Tel: +91 904 999 0855
Email: mayur.shinde@tmsprecisiontech.com
Web: www.tmsprecisiontech.com

IRAN

plan:b4u GmbH

Colmarplatz 1 / Top XXIII
7000 Eisenstadt Austria
Tel: +43 664 127 3039
Email: info@planb4u.com
Web: www.planb4u.com

IRAQ

plan:b4u GmbH

Colmarplatz 1 / Top XXIII
7000 Eisenstadt Austria
Tel: +43 664 127 3039
Email: info@planb4u.com
Web: www.planb4u.com

ISRAEL

De-Paz Machinery - CNC machines & Accessories

Menachem Begin 80 Blvd
Afula. 1871356 Israel
Tel: +972-54-421 48 72
Email: zion@de-paz.com
Web: www.de-paz.com

JAPAN

Vollmer Japan Corp.

Haraichi 283-1
362-0021, Ageo-Shi
Saitama-Ken Japan
Tel: +81-48 795 4110
Fax: +81-48 795 4112
Email: INFO-JAPAN@VOLLMER-GROUP.COM

KAZAKHSTAN

AWM Precision GmbH

Genshagener Straße 27
14974 Ludwigsfelde Germany
Tel: +49 (0) 33 78 - 5 18 63 67
Email: arnold@awm-precision.com
Web: www.awm-precision.com

KOREA

Central Technology Co. Ltd

D-1311, Gwangmyeong Techno Park, Haanro 60,
Gwangmyeong-Si, Gyeonggi-Do, 423-050 Korea
Tel: +82-2-897-0945
Fax: +82-2-897-0943
Email: ycr@centraltech.co.kr
Web: www.centraltech.co.kr

KUWAIT

plan:b4u GmbH

Colmarplatz 1 / Top XXIII
7000 Eisenstadt Austria
Tel: +43 664 127 3039
Email: info@planb4u.com
Web: www.planb4u.com

OMAN

plan:b4u GmbH

Colmarplatz 1 / Top XXIII
7000 Eisenstadt Austria
Tel: +43 664 127 3039
Email: info@planb4u.com
Web: www.planb4u.com

PACIFIC

(Indonesia, Malaysia, Singapore)

VOLLMER Asia Pacific Co., Ltd.

20th Floor, SJ Infinite One Business Complex
Unit 2001-2005
349 Vibhavadi-Rangsit Road, Chompol
Chatuchak, Bangkok, 10900 Thailand

QATAR

plan:b4u GmbH

Colmarplatz 1 / Top XXIII
7000 Eisenstadt Austria
Tel: +43 664 127 3039
Email: info@planb4u.com
Web: www.planb4u.com

RUSSIA

AWM Precision GmbH

Genshagener Straße 27
14974 Ludwigsfelde Germany
Tel: +49 (0) 33 78 - 5 18 63 67
Email: arnold@awm-precision.com
Web: www.awm-precision.com

SAUDI ARABIA

plan:b4u GmbH

Colmarplatz 1 / Top XXIII
7000 Eisenstadt Austria
Tel: +43 664 127 3039
Email: info@planb4u.com
Web: www.planb4u.com

TAIWAN

HERZOG Taiwan Co., Ltd.

10F, No.70 Gongyequ 1st Rd., Situn Dist.
Taichung City 40766, Taiwan (R.O.C.)
Tel: +886-4-23 55-33 88
Fax: +886-4-23 55-22 99
Email: afly@costa.com.tw
Web: www.costa.com.tw

THAILAND

VOLLMER Asia Pacific Co., Ltd.

20th Floor, SJ Infinite One Business Complex
Unit 2001-2005
349 Vibhavadi-Rangsit Road, Chompol
Chatuchak, Bangkok, 10900 Thailand

TURKEY

Mikron Otomasyon ve CNC Teknolojileri

Yeni mahalle Yalı sokak
Panorama Life Sitesi Nu:1
34882 Yakacık Kartal Istanbul
Tel: +90 216 671 03 24
Email: info@mikronotomasyon.com
Web: www.mikronotomasyon.com

UNITED ARAB EMIRATES

plan:b4u GmbH

Colmarplatz 1 / Top XXIII
7000 Eisenstadt Austria
Tel: +43 664 127 3039
Email: info@planb4u.com
Web: www.planb4u.com

VIETNAM

Central Technology Co. Ltd

D-1311, Gwangmyeong Techno Park, Haanro 60,
Gwangmyeong-Si, Gyeonggi-Do, 423-050
Korea
Tel: +82-2-897-0945
Fax: +82-2-897-0943
Email: ycr@centraltech.co.kr
Web: www.centraltech.co.kr



ALGERIA

oelheld technologies SAS

innovative fluid technology
Technopôle de Forbach-Sud
140, Avenue Jean-Eric Bousch
57600 Oeting France
Tel: +33 (0) 387-90 42 14
Fax: +33 (0) 387-84 66 91
Email: martin.gundelach@oelheld.de
Web: www.oelheld.com

AUSTRALIA

Camco Cutting Tools Int'l Pty. Ltd.

1/25 Mareno Rd., P.O. Box 1575,
Tullamarine, Victoria, 3043 Australia
Tel: +61 (0)3 8336 1500
Fax: +61 (0)3 8336 1499
Mob: +61 (0)413 126 868
Email: sales@camcointl.com

BRAZIL

Metalsystem

Rua João Pereira Chaves, 440
RS 93032-320 Jardim America, São Leopoldo Brazil
Tel: +55 51 8159-8455
Email: Vendas@metalsystem.ind.br
Email: renato@metalsystem.ind.br
Web: www.metalsystem.ind.br

CANADA

Toolroom Solutions Inc.

Ed Sinkora
8824 Old Block House Ln
22551 Spotsylvania USA
Tel: +1 540 9 40 - 59 77
Email: ed@toolroom.solutions

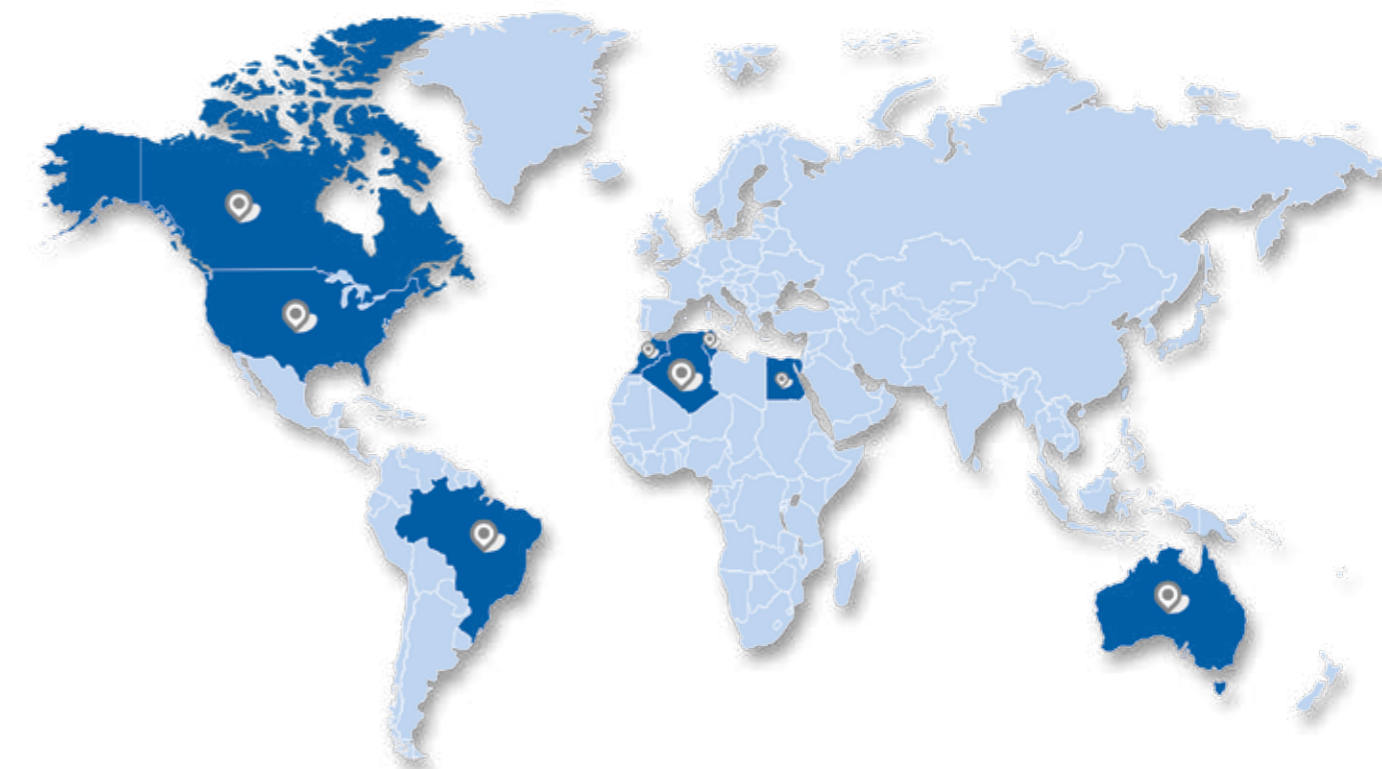

MOROCCO

oelheld technologies SAS

innovative fluid technology
Technopôle de Forbach-Sud
140, Avenue Jean-Eric Bousch
57600 Oeting France
Tel: +33 (0) 387-90 42 14
Fax: +33 (0) 387-84 66 91
Email: martin.gundelach@oelheld.de
Web: www.oelheld.com

TUNISIA

oelheld technologies SAS

innovative fluid technology
Technopôle de Forbach-Sud
140, Avenue Jean-Eric Bousch
57600 Oeting France
Tel: +33 (0) 387-90 42 14
Fax: +33 (0) 387-84 66 91
Email: martin.gundelach@oelheld.de
Web: www.oelheld.com

USA

Toolroom Solutions Inc.

Ed Sinkora
8824 Old Block House Ln
22551 Spotsylvania USA
Tel: +1 540 9 40 - 59 77
Email: ed@toolroom.solutions

REVOLUTION IN TOOLGRINDING

